

HYUNDAI Genuine Accessories



Vehicle Model Multiple
Part No. 00048 ADU00

Accessory Door Cup Urethane
Difficulty (B)

• Accessory Installation

Note: Difficulty stated above reflects the minimum level of expertise required to install the accessory.
(A) Customer (B) Dealer Technician (C) Master Technician

Instructional Symbols / Definitions

	Denotes warnings that may lead to serious physical injury or vehicle damage.		Denotes quality processes to be checked prior to moving to the next step.	Denotes safety equipment required to be used such as a mask, goggles, rubber gloves, and hearing protection.	
	Denotes cautions to be taken to avoid physical injury or electronic component damage.		Denotes specific tools that are necessary to complete the step.		
	Denotes cautions to be taken to avoid vehicle and component damage.	NOTE	Denotes instructional steps necessary to complete the process.		
				Mask	Safety Glasses
				Gloves	Hearing Protection

Basic Required Hand Tools

				FMVSS 110 Compliance Information Part Number 00048 ADU00 0.00353 lbs. 1.60 grams (Gross Weight)		All dealers must determine if the weight they have added in the form of all options or accessories, when added to the weight of all Port Installed options or accessories, exceeds the lesser of 1.5% of GVWR or 100 lbs. If the additional weight does exceed the lesser of the indicated thresholds, a "Load Carrying Capacity Reduced" label must be installed. A black, fine-point, indelible marker must be used to write by hand onto the label, the reduced carrying capacity in kilograms or pounds, which is the total weight of all added options and accessories. Load Label Part Number: NP070-09003
50/50 Isopropyl Alcohol (70%) & Water (Cleaning Mixture)	Shampoo & Water (SLIP Mixture)	Squeegee	Microfiber Cloth			

Notes to the Installer :

1. Read the entire installation instructions prior to beginning the installation of this accessory.
2. Make sure the vehicle is completely clean before the accessory is installed.
3. Ensure the vehicle is properly protected in the area(s) that the accessory is to be installed.
4. To prevent vehicle damage, never place tools on top of painted surfaces, seats, dash pad, console or floor carpet/mats.
5. Always wear appropriate safety gear to include gloves and safety glasses when required.
6. After installation, do not wash vehicle for 24 hours.

Preparation - Before Installation :

1. **Water & Shampoo:** Mix 26oz of distilled water and 15ml of baby shampoo in a trigger type spray bottle marked "Slip". **Note:** The above listed solution has been formulated for use where ambient and vehicle surface temperature are within a range of 65°F to 90°F. If temperatures are outside this range, make incremental adjustments to the solution as necessary.
2. This product should be installed with proper installation tools.
3. Install this product while observing all warnings and precautions stated in this instruction booklet.
4. **VERY IMPORTANT:** Thoroughly wash vehicle with soap and water where Door Cup Urethane will be applied. If contaminants are found, clean with an automotive grade clay bar (follow instructions provided with clay bar).
5. It is recommended that the ambient temperature of the accessory and vehicle be between 65°F to 90°F at the time of installation and for two hours after.
6. Parts storage should be flat at room temperature and in a clean dry place. **Care should be taken to avoid a dusty environment.**
7. Place a large towel or pad on the ground to catch wetting mixture.
8. Make sure you have a clean, flat table/work area to use.

HYUNDAI Genuine Accessories

Kit Overview

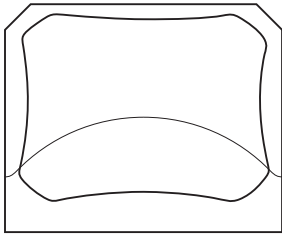

1

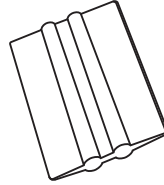



2

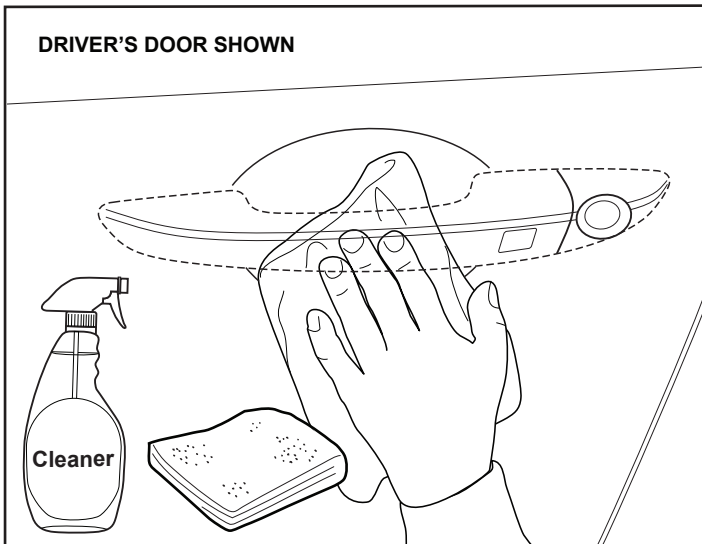

3

No.	Qty.	Description
1	6	Door Cup Urethane
2	1	Squeegee
3	1	Instructions



 Isopropyl Alcohol (70%) & Water Mixture in a Spray Bottle and a Microfiber Cloth. 1

NOTE
1. Thoroughly clean the door handle cup area using the Isopropyl Alcohol & Water Mixture and a Microfiber Cloth.

 Make sure application area is completely clean and dried. Inspect area for contaminates. Clean surface with an automotive quality clay bar if required.

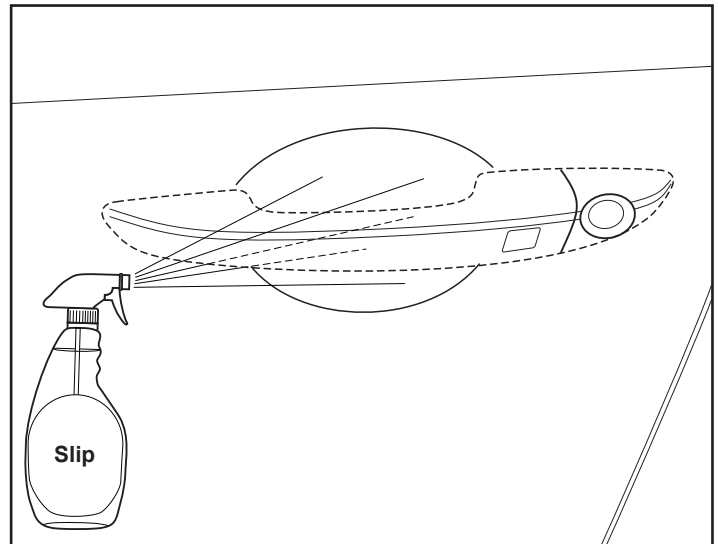

 Shampoo & Water Mixture in a Spray Bottle 2

NOTE
1. Lightly spray the door handle cup area that will receive the Door Cup Urethane.

 Make sure application area is completely clean and dried. Inspect area for contaminates. Clean surface with an automotive quality clay bar if required.

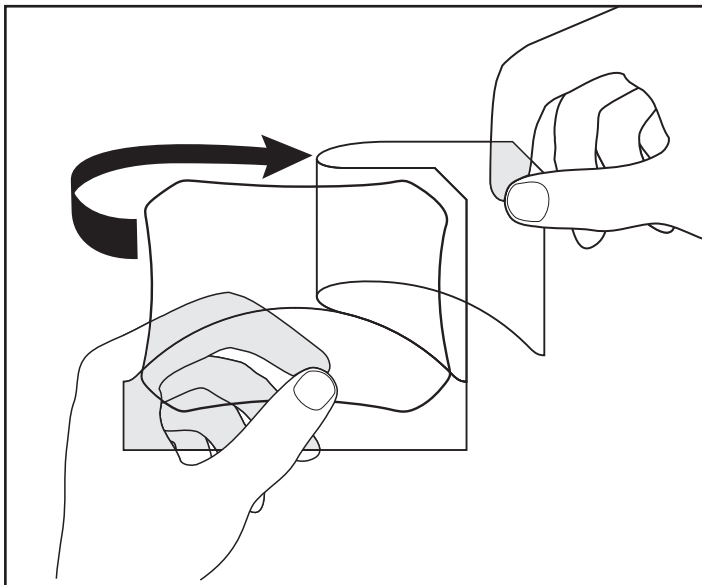

3

NOTE
1. Hold Door Cup Urethane at bottom & remove top part of liner.

 Pay special attention to not get any finger prints or dirt on the Door Cup Urethane.

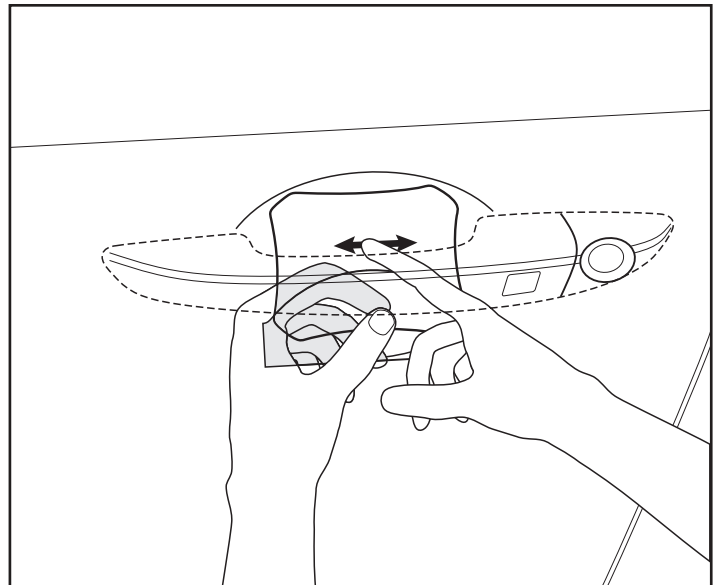



4

NOTE
1. Using index finger, rub center of Door Cup Urethane to tack it down.



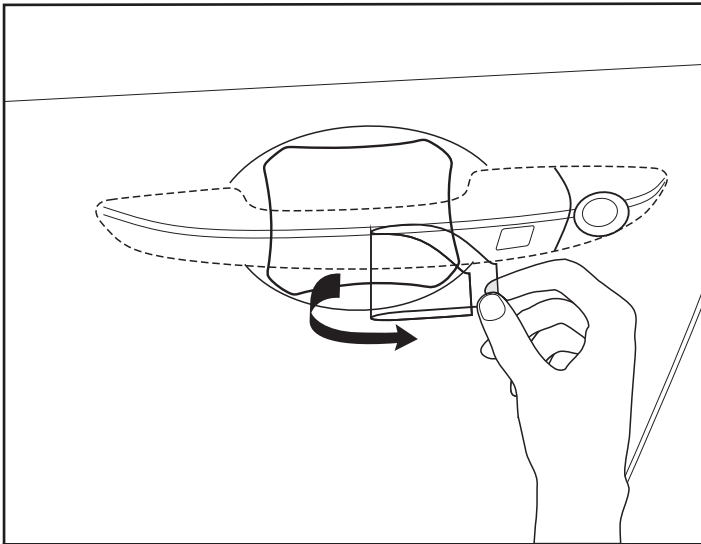

HYUNDAI Genuine Accessories



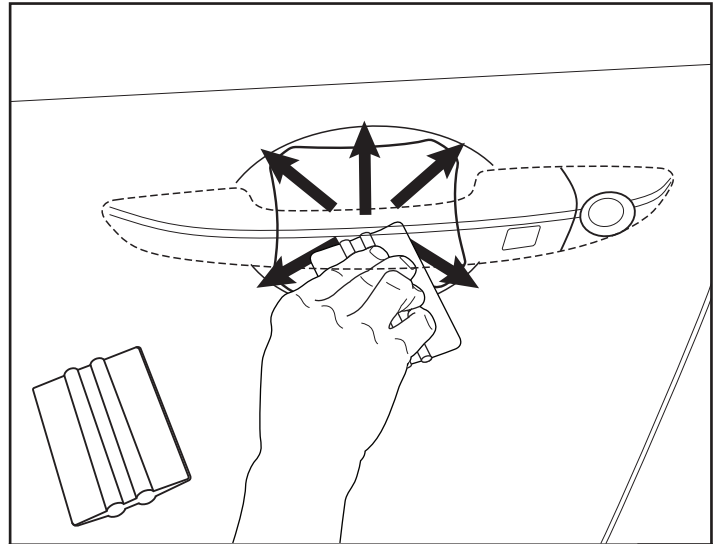



		1
N O T E	1. Remove the remaining bottom part of liner.	
	Pay special attention to not get any finger prints or dirt on the Door Cup Urethane.	



	Squeegee	2
N O T E	1. Squeegee the Door Cup Urethane from the center out using overlapping strokes.	
	Inspect the Door Cup Urethane and ensure it is securely adhered to surface.	

HYUNDAI Genuine Accessories
Visual Check

Items To Be Checked		Results Of The Check
	Use only the handling tabs when handling the Door Cup Urethane. Pay special attention to not get any finger prints or dirt on the Urethane adhesive.	No dirt or finger prints on Door Cup Urethane.
	Make sure Door Cup Urethane is fully adhered.	Door Cup Urethane is not lifting and is fully adhered. Take special care to make sure all edges are fully adhered.
	Make sure Door Cup Urethane is free of any remaining adhesive after installation. Clean the Door Cup Urethane with soap and water if necessary.	No adhesive remaining on Door Cup Urethane.
	If an installation error occurs, i.e., scratched / marred Door Cup Urethane, dirt / debris under Urethane, crooked installation, etc., installer should remove, discard and replace the Door Cup Urethane.	Door Cup Urethane is installed correctly.