



## HYUNDAI Genuine Accessories

Vehicle Model	Santa Fe	Accessory	Sport Visor
Model Year	2013 ~	Difficulty	( B )
Part No.	B8022 ADU00		

- Accessory Installation

**Note:** Difficulty stated above reflects the minimum level of expertise required to install the accessory.

( A ) Customer ( B ) Dealer Technician ( C ) Master Technician

### Instructional Symbols / Definitions

	Denotes warnings that may lead to serious physical injury or vehicle damage.		Denotes quality processes to be checked prior to moving to the next step.	Denotes safety equipment required to be used such as a mask, safety glasses, gloves, and hearing protection.	
	Denotes cautions to be taken to avoid physical injury or electronic component damage.		Denotes specific tools that are necessary to complete the step.		
	Denotes cautions to be taken to avoid vehicle and component damage.		Denotes instructional steps necessary to complete the process.		

### Basic Required Hand Tools

				<b>FMVSS 110 Compliance Information</b>  <b>Part Number: B8022 ADU00</b>  <b>2.12 lbs 0.96 kg (Gross Weight)</b>	All dealers must determine if the weight they have added in the form of all options or accessories, when added to the weight of all Port/Dealer Installed options or accessories, exceeds the lesser of 1.5% of GVWR or 100 lbs. If the additional weight does exceed the lesser of the indicated thresholds, a "Load Carrying Capacity Reduced" label must be installed. A black, fine-point, indelible marker must be used to write by hand onto the label, the reduced carrying capacity in kilograms or pounds, which is the total weight of all added options and accessories. Load Label Part Number: NP070 - 09003
Ruler	Soap & Water	Lint Free Cloth	Non-Permanent Marker or Pencil		

### Notes to the Installer:

Adhesives used in this product are sensitive to temperature during installation, only install this product to the vehicle if the temperature is between (60° - 80°F \ 15° - 27°C). Installing the parts to the vehicle outside of this temperature may lead to a reduced level of performance.

Installation of all parts should not occur in direct sunlight or if the vehicle has been parked in direct sunlight and is hot as a result. Both the parts and the vehicle should be at the same temperature (60° - 80°F \ 15° - 27°C) during the installation to ensure maximum adhesion.

Read the entire installation instructions prior to beginning the installation of this accessory.

Make sure the vehicle is completely clean before the accessory is installed.

Ensure the vehicle is properly protected in the area(s) that the accessory is to be installed.

To prevent vehicle damage, never place tools on top of painted surfaces, seats, dash pad, console or floor carpet/mats.

Always wear appropriate safety gear to include gloves and safety glasses when required.

HYUNDAI Genuine Accessories

Kit Overview

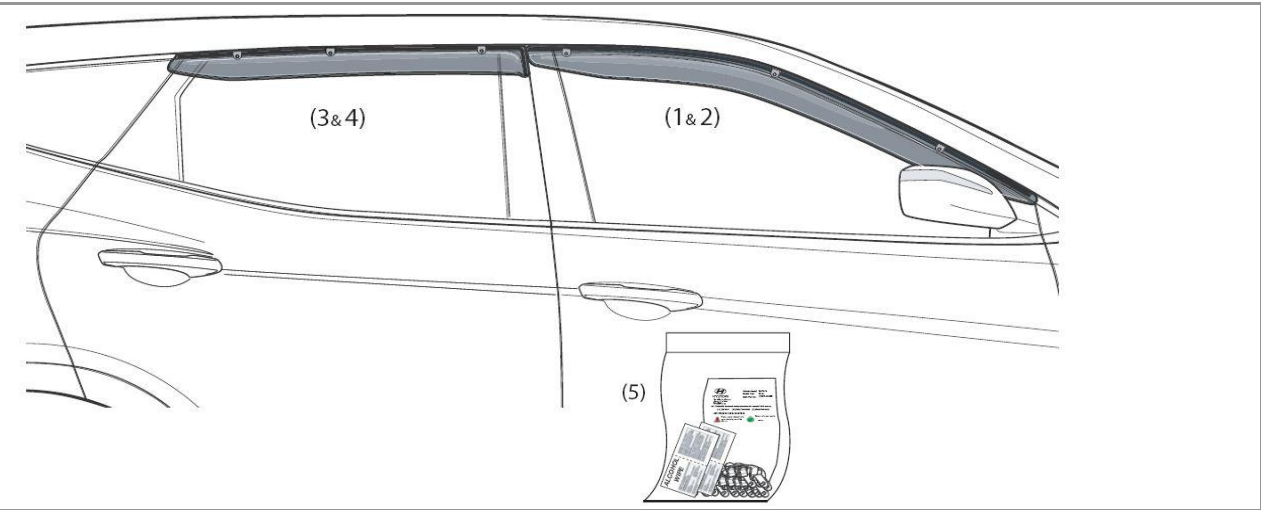

No.	Qty.	Description
1	1	Front RH Sport Visor
2	1	Front LH Sport Visor
3	1	Rear RH Sport Visor
4	1	Rear LH Sport Visor
5	1	Hardware Kit

Hardware Overview

A	
12	Metal Clips

B	
4	Alcohol Wipe

C	
12	Push Rivet

D	
1	Installation Instructions

Hardware Total
29

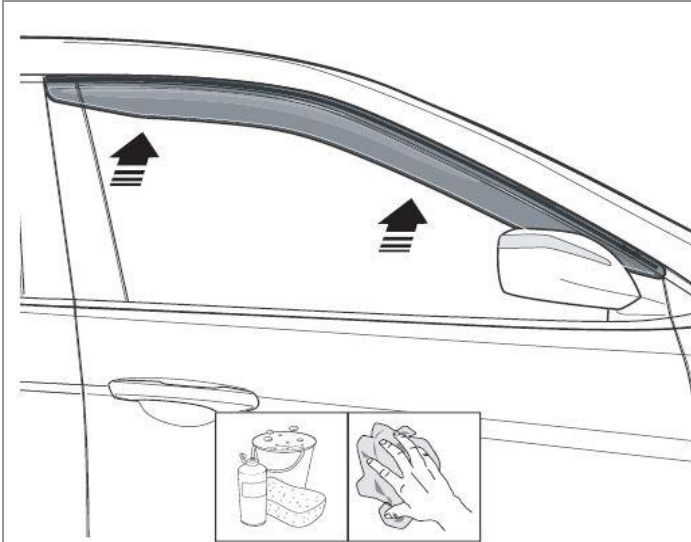

**Soap & Water and Lint Free Cloth** 1

NOTE

1. Thoroughly clean the Front RH upper door frame and surrounding areas.
2. Wipe away any residue and allow to completely dry.
3. Lower the window.



**Make sure all surfaces are completely dry before trial fitting the Front RH Sport Visor.**

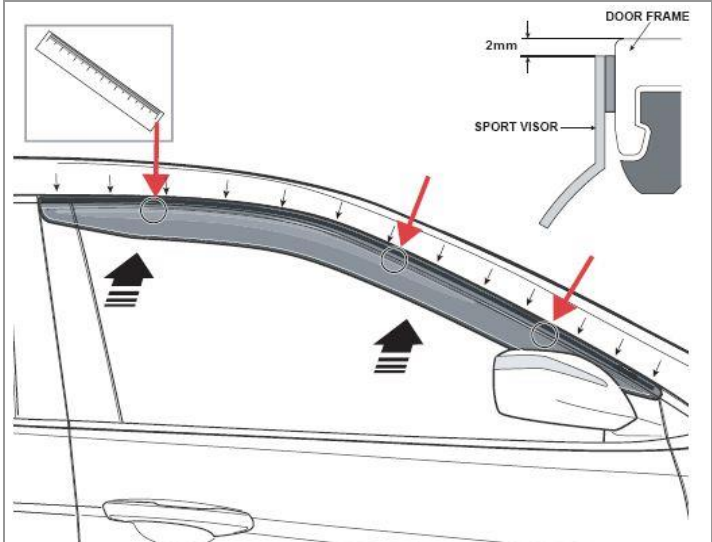

**Non-Permanent Marker or Pencil and Ruler** 2

NOTE

1. Remove the protective film from the Front RH Sport Visor.
2. Trial fit the Front RH Sport Visor onto the door frame. Align the top edge of the Sport Visor 2mm below the top of the door edge, while locating the front edge of the Sport Visor 2mm from the door edge.
3. Mark the location of the three (3) holes in the Sport Visor where they correspond to the door frame as shown.



**Make sure all surfaces are completely dry before proceeding to the next step.**

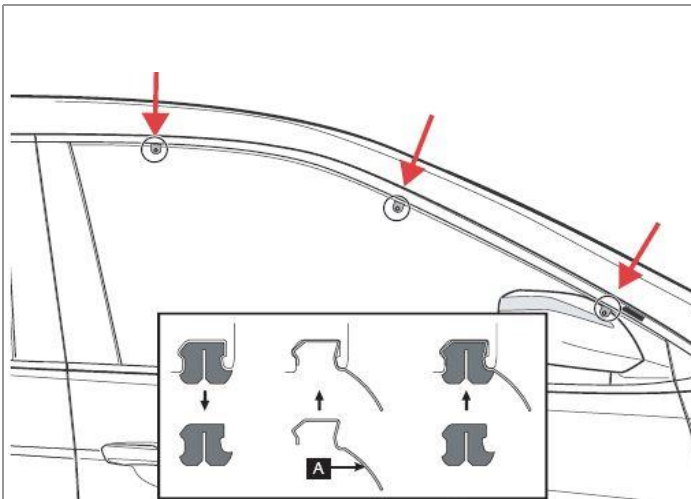

**Lint Free Cloth** 3

NOTE

1. Starting at the center, dislodge the rubber window seal from the door frame. Do not remove the seal from the front or rear corners of the door frame.
2. Install one (1) Metal Clip between the door frame and the rubber window seal at the front marked position.
3. Install one (1) Metal Clip at the rear marked position.
4. Install one (1) Metal Clip at the center marked position.
5. Reinstall the rubber window seal into the door frame. Ensure that the seal is fully seated.



**Ensure the rubber window seal is correctly seated. Be careful not to damage the rubber window seal.**

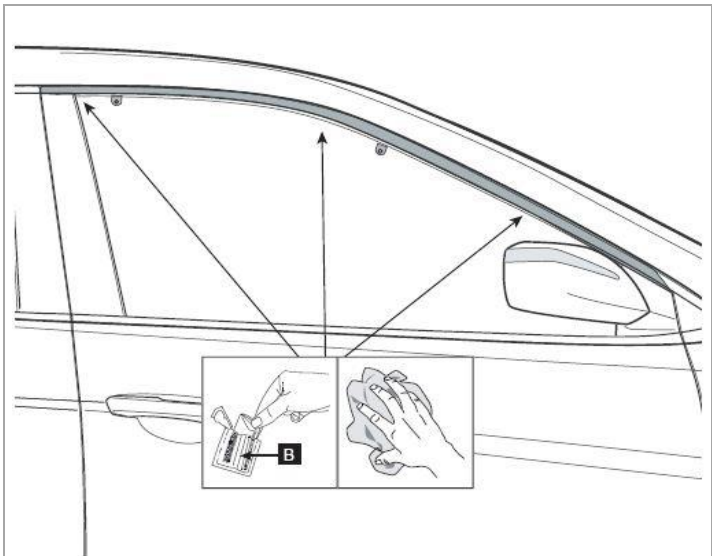

**Lint Free Cloth** 4

NOTE

1. Using one (1) provided Alcohol Prep Pad, thoroughly clean the tape attachment areas as shown.
  - Make sure to remove any marks from the Non-Permanent Marker or Pencil.
2. Wipe away any remaining residue.



**Do not touch the areas that have been cleaned. Do not install if the Door Frame is wet or outside the temperature range indicated on page 1.**

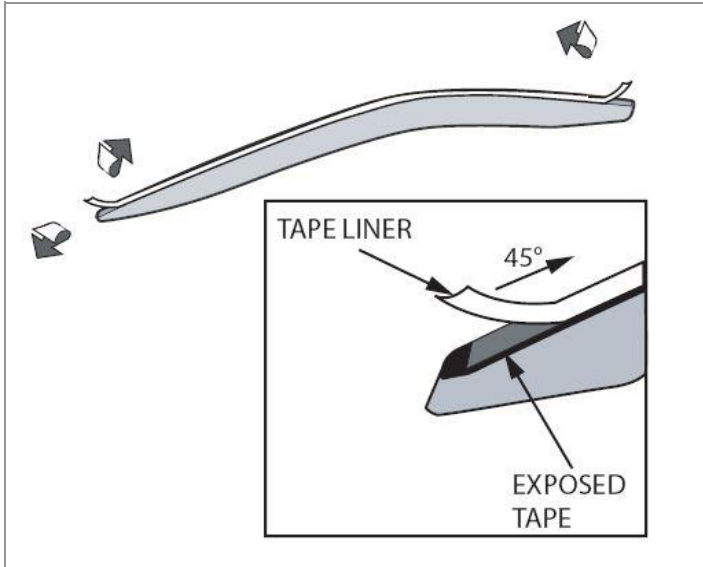

	5
<b>NOTE</b>	1. Peel back approximately 50mm (2") of the tape liner at each end, then fold at 45° to the outside of the Sport Visor as shown.
	Do not touch the exposed tape with your hands, allow to get dirty, or leave exposed for an extended period of time.

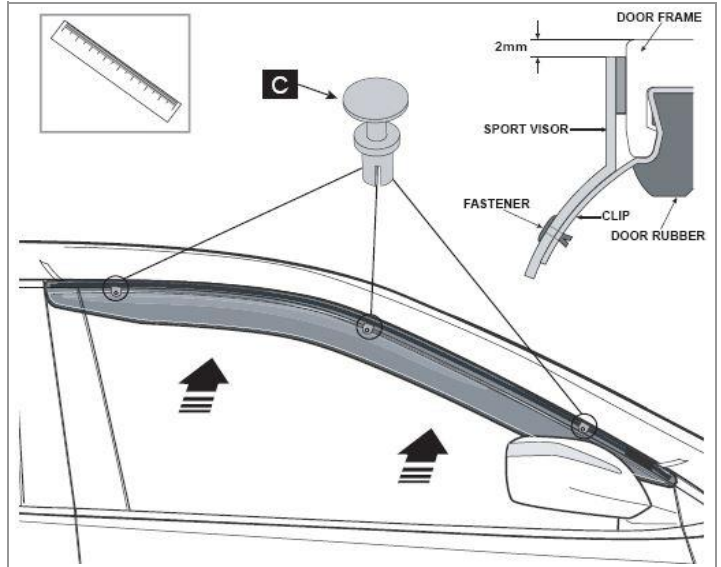

	Ruler	6
<b>NOTE</b>	1. Align the top edge of the Sport Visor 2mm below the top of the door edge while locating the front edge of the Sport Visor 2mm from the door edge. 2. Ensure the tape liners are exposed (refer to step 5). 3. Install three (3) Push Rivets through the Sport Visor into the three (3) Metal Clips. Press down on the center of each Push Rivet to engage.	
	Apply only light pressure to the front and rear corners of the Sport Visor when installing the Push Rivets.	

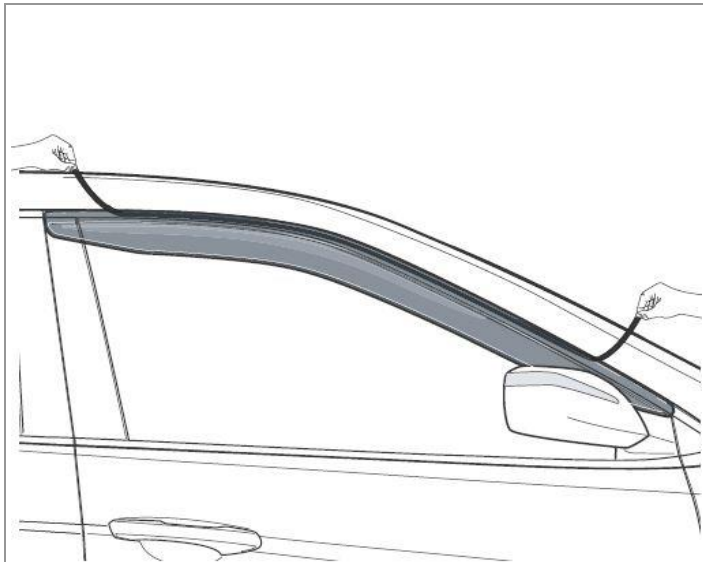

	7
<b>NOTE</b>	1. Fully remove and discard the tape liner by pulling from both ends as shown.
	Be careful not to tear the tape liner during removal.

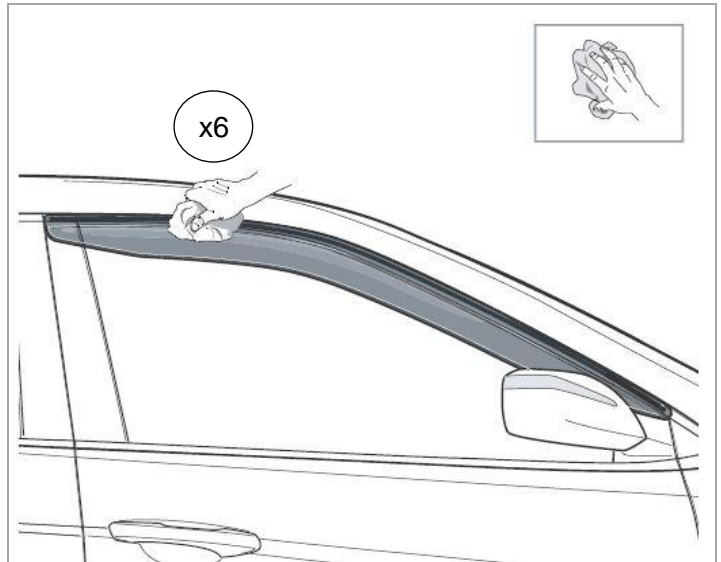

	Lint Free Cloth	8
<b>NOTE</b>	1. Using a Lint Free Cloth, apply firm downward pressure to the entire tape flange six (6) times to promote maximum adhesion of the Sport Visor to the door frame. 2. Repeat steps 1 - 8 for the Front LH Sport Visor.	
	It is critical that the part is correctly pressed down and the Metal Clips are properly fitted to ensure the function of the part.	

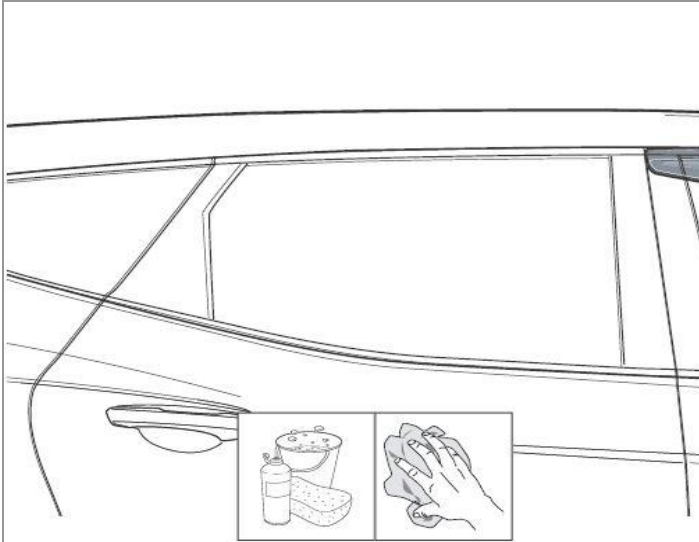

**Soap & Water and Lint Free Cloth** 9

NOTE

1. Thoroughly clean the Rear RH upper door frame and surrounding areas.
2. Wipe away any residue and allow to completely dry.
3. Lower the window.



**Make sure all surfaces are completely dry before trial fitting the Front RH Sport Visor.**

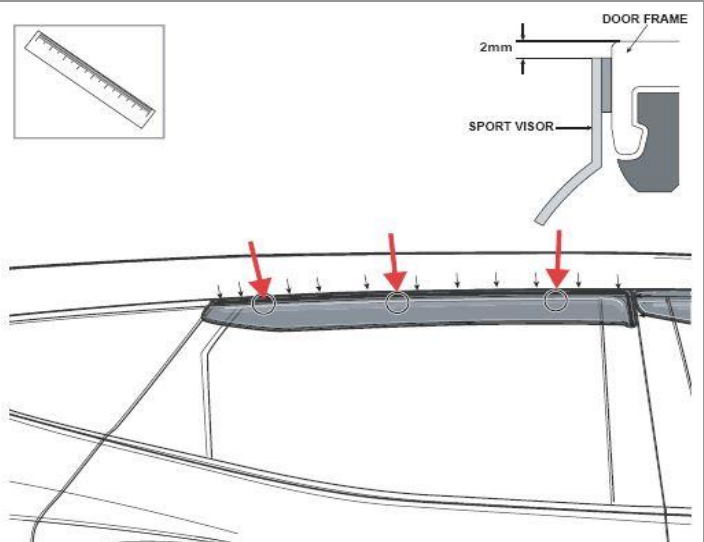

**Non-Permanent Marker or Pencil and Ruler** 10

NOTE

1. Remove the protective film from the Rear RH Sport Visor.
2. Trial fit the Rear RH Sport Visor onto the door frame. Align the top edge of the Sport Visor 2mm below the top of the door edge, while locating the front edge of the Sport Visor 2mm from the door edge.
3. Mark the location of the three (3) holes in the Sport Visor where they correspond to the door frame as shown.



**Make sure all surfaces are completely dry before proceeding to the next step.**

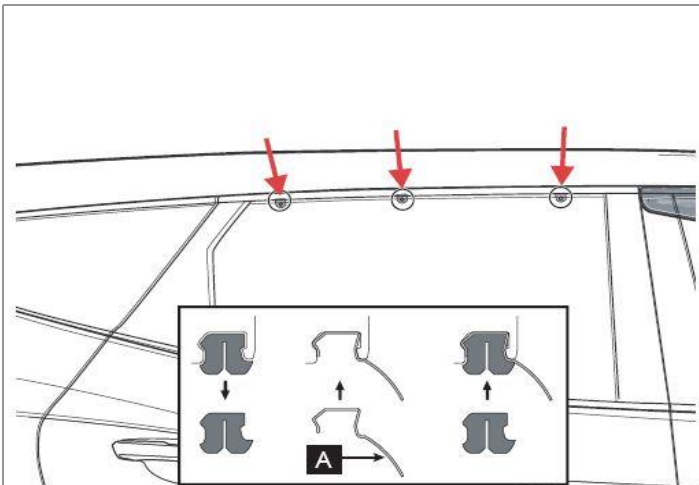

**Lint Free Cloth** 11

NOTE

1. Starting at the center, dislodge the rubber window seal from the door frame. Do not remove the seal from the front or rear corners of the door frame.
2. Install one (1) Metal Clip between the door frame and the rubber window seal at the front marked position.
3. Install one (1) Metal Clip at the rear marked position.
4. Install one (1) Metal Clip at the center marked position.
5. Reinstall the rubber window seal into the door frame. Ensure that the seal is fully seated.



**Ensure the rubber window seal is correctly seated. Be careful not to damage the rubber window seal.**

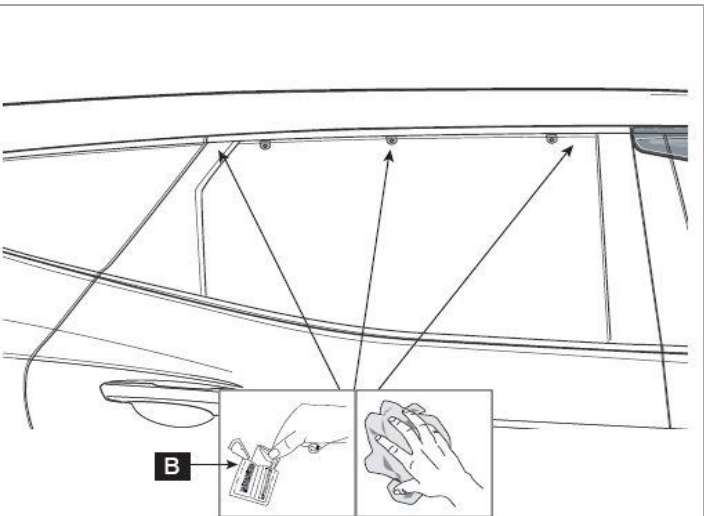

**Lint Free Cloth** 12

NOTE

1. Using one (1) provided Alcohol Prep Pad, thoroughly clean the tape attachment areas as shown.
  - Make sure to remove any marks from the Non-Permanent Marker or Pencil.
2. Wipe away any remaining residue.



**Do not touch the areas that have been cleaned. Do not install if the Door Frame is wet or outside the temperature range indicated on page 1.**



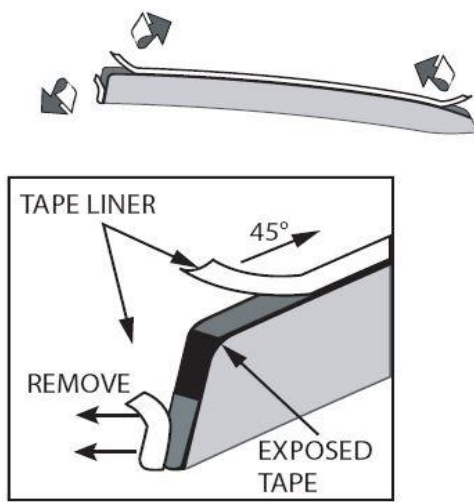

13

NOTE

1. Peel back approximately 50mm (2") of the tape liner at each end, then fold at 45° to the outside of the Sport Visor as shown.
2. Fully remove the small vertical tape liner.



Do not touch the exposed tape with your hands, allow to get dirty, or leave exposed for an extended period of time.

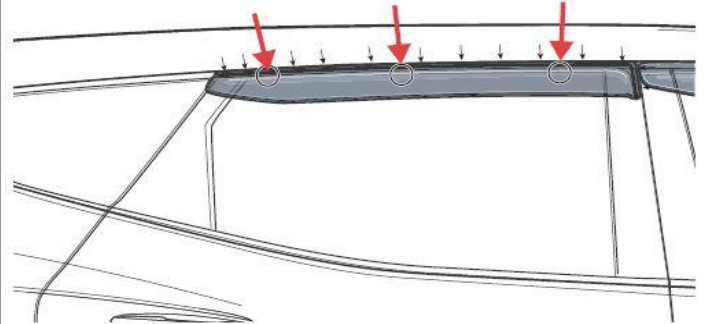
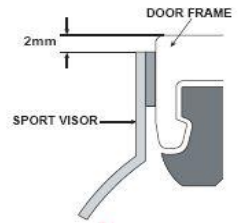

Ruler

14

NOTE

1. Align the top edge of the Sport Visor 2mm below the top of the door edge while locating the front edge of the Sport Visor 2mm from the door edge.
2. Ensure the tape liners are exposed (refer to step 13).
3. Install three (3) Push Rivets through the Sport Visor into the three (3) Metal Clips. Press down on the center of each Push Rivet to engage.



Apply only light pressure to the front and rear corners of the Sport Visor when installing the Push Rivets.

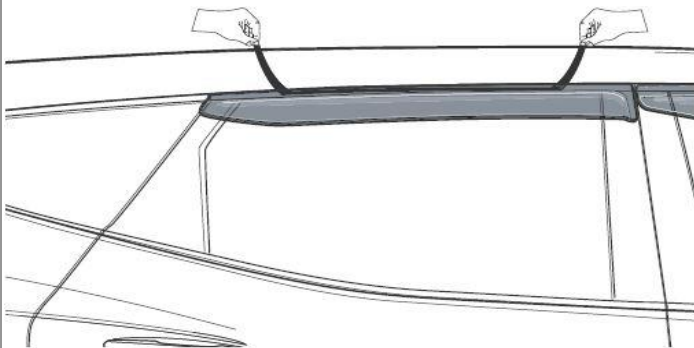

15

NOTE

1. Fully remove and discard the tape liner by pulling from both ends as shown.



Be careful not to tear the tape liner during removal.

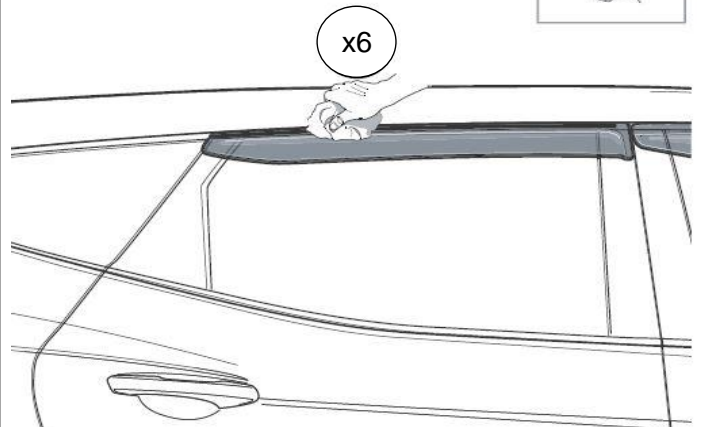

Lint Free Cloth

16



NOTE

1. Using a Lint Free Cloth, apply firm downward pressure to the entire tape flange six (6) times to promote maximum adhesion of the Sport Visor to the door frame.
2. Repeat steps 9 - 16 for the Rear LH Sport Visor.



It is critical that the part is correctly pressed down and the Metal Clips are properly fitted to ensure the function of the part.

## HYUNDAI Genuine Accessories Visual Check

Items To Be Checked		Results Of The Check
	Check the position of the Sport Visor to make sure that it is positioned correctly (step 6 and 14).	Sport Visor has correct fitment.
	Conduct a final inspection, ensuring that all Metal Clips and Push Rivets are correctly installed and fully engaged. Close all doors and windows, then check clearances at all edges for interference.	Sport Visor has correct fitment.

## **HYUNDAI Genuine Accessories Cleaning Instructions**

### **Cleaning Instructions:**

Spray with a firm water spray to remove any loose dirt, then wash with water, detergent and a soft cloth or sponge. DO NOT use petroleum based solvents or abrasives.

Retain these instructions in the vehicle Glove Box for future reference.